

ENERGY SAVINGS BOX

# Quick Start Guide

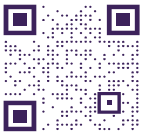
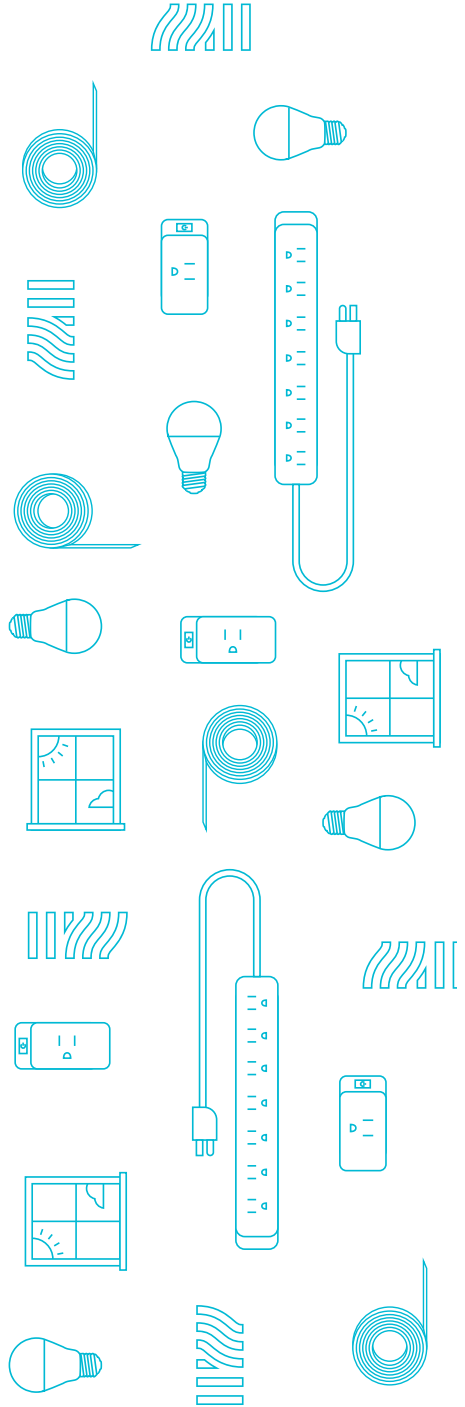

For video instructions,  
please scan here.

Voltear para Español





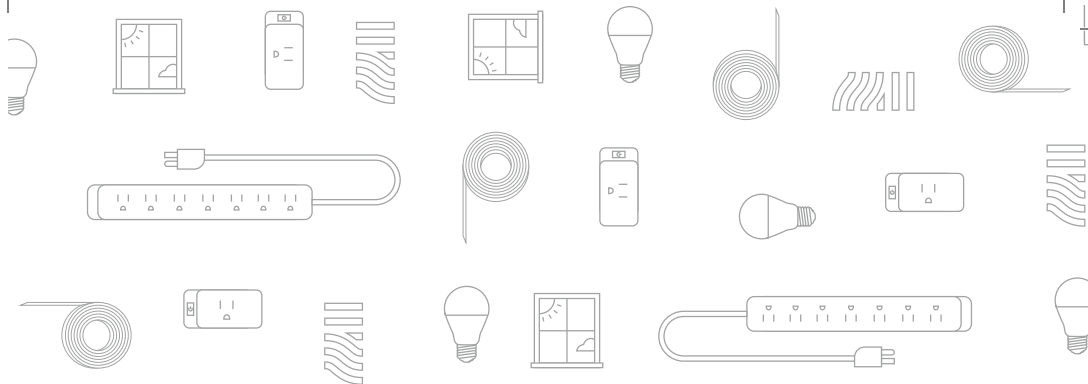

## What's Inside

LED Light Bulbs   2 Varieties, 6 Bulbs Total	4
Smart Socket   WiFi & Bluetooth Enabled	6
Advanced Power Strip   7 Outlets	8
Weather Proofing   3 Unique Solutions	
- Weather Stripping (Door)   Peel-and-Stick	10
- V-Seal Weather Stripping (Window)   Adhesive-Backed	12
- Rope Caulk (Window)   No-Mess, Self-Sticking	14
What to do if you can't use everything	16

# LED Light Bulbs

## 2 VARIETIES

LEDs save 80% more energy and last 22 times longer than incandescent bulbs. Use them indoors or outdoors—they fit in standard sockets and won't overheat enclosed fixtures.

- **Set of three 11-Watt LED (75W equivalent)**  
Multipurpose use for table lamps, bathroom lights, and outdoors.
- **Set of three 13-Watt LED (100W equivalent)**  
Good for large areas, ceiling fans, chandeliers, and floor lamps.

## Instructions

- 1 Turn off the switch.

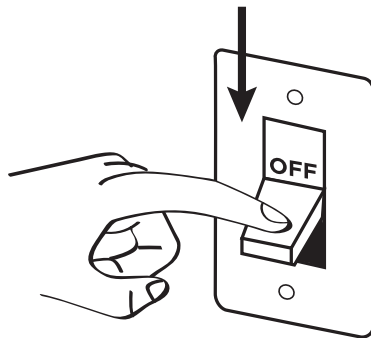

- 2 Make sure the bulb is not hot.

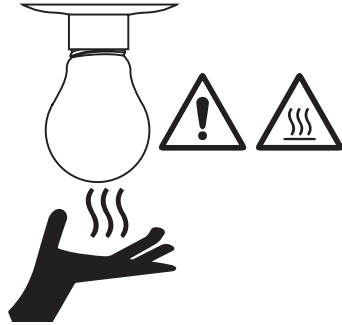

- 3 Remove the old bulb.

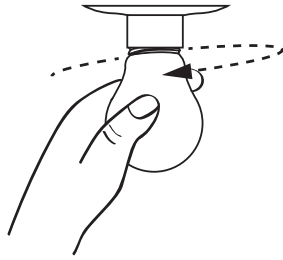

- 4 Screw in the new bulb.

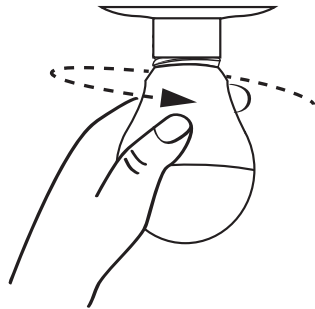

- 5 Turn on the switch.

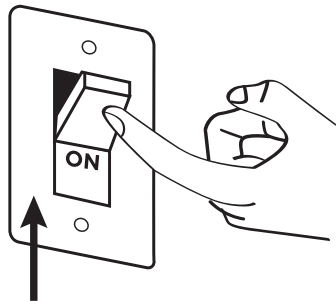

# Smart Socket

## WIFI & BLUETOOTH ENABLED

Save power effortlessly with Simply Conserve®, which allows you to control devices and appliances from anywhere. Just plug your appliance into the Smart Socket, connect to Wi-Fi, and control it via the app, Amazon Alexa, or Google Assistant.

- Automatically turns appliances On/Off
- Adjust timers to fit your busy schedule
- Easy-to-use, convenient mobile app

## Instructions

- 1 Download the Simply Conserve® app.
- 2 After the app has been downloaded, follow the prompts to set up your account.



3

Plug in the WiFi Smart Socket into an available wall outlet.

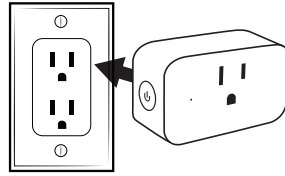

4

Switch the power to the "on" position on the WiFi Smart Socket. If not connecting, ensure Bluetooth is on.

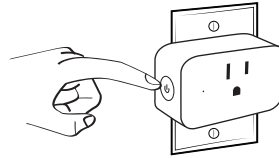

5

Follow the instructions in the app to add a device.



6

The LED status light will blink. Once your device has been added, the status light will stop blinking and become solid.

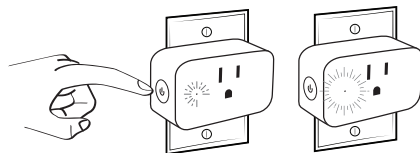

7

Click "confirm" once your device(s) have successfully been added to the Simply Conserve® app.



# Advanced Power Strip

## 7 OUTLETS

This power strip conserves energy by cutting power to devices like speakers or printers when not in use, preventing electricity consumption when in standby mode or when turned off. Optimize power usage across 4 occasionally used devices and prioritize energy to 3 always-on devices.

- Surge protection for appliances and electronics
- 6-foot cord provides flexibility for different spaces
- Includes child protective outlet covers

## Key terminology:

### Always On

These outlets provide power at all times and can be turned on or off at any time.

Best for:  
Routers, modems, cable, satellite.

### Control (Master)

A primary device plugged into the Control outlet always receives power. When the primary device in the Control/Master outlet is turned off, devices in the Switched outlets do not receive power. Think of this as a switch simultaneously turning multiple devices on or off.

Best for:  
TV, computer.

### Switched

Devices plugged into Switched outlets will receive power when the primary device (in the Control/Master Outlet) is powered on. Avoid using these outlets for anything used when the Control device is off.

Best for:  
Game console, DVD player, printer, speakers.



# Plugging in your devices

Plug the device into the socket type on the strip based on their label ("Always-on," "Control/Master," "Switched").

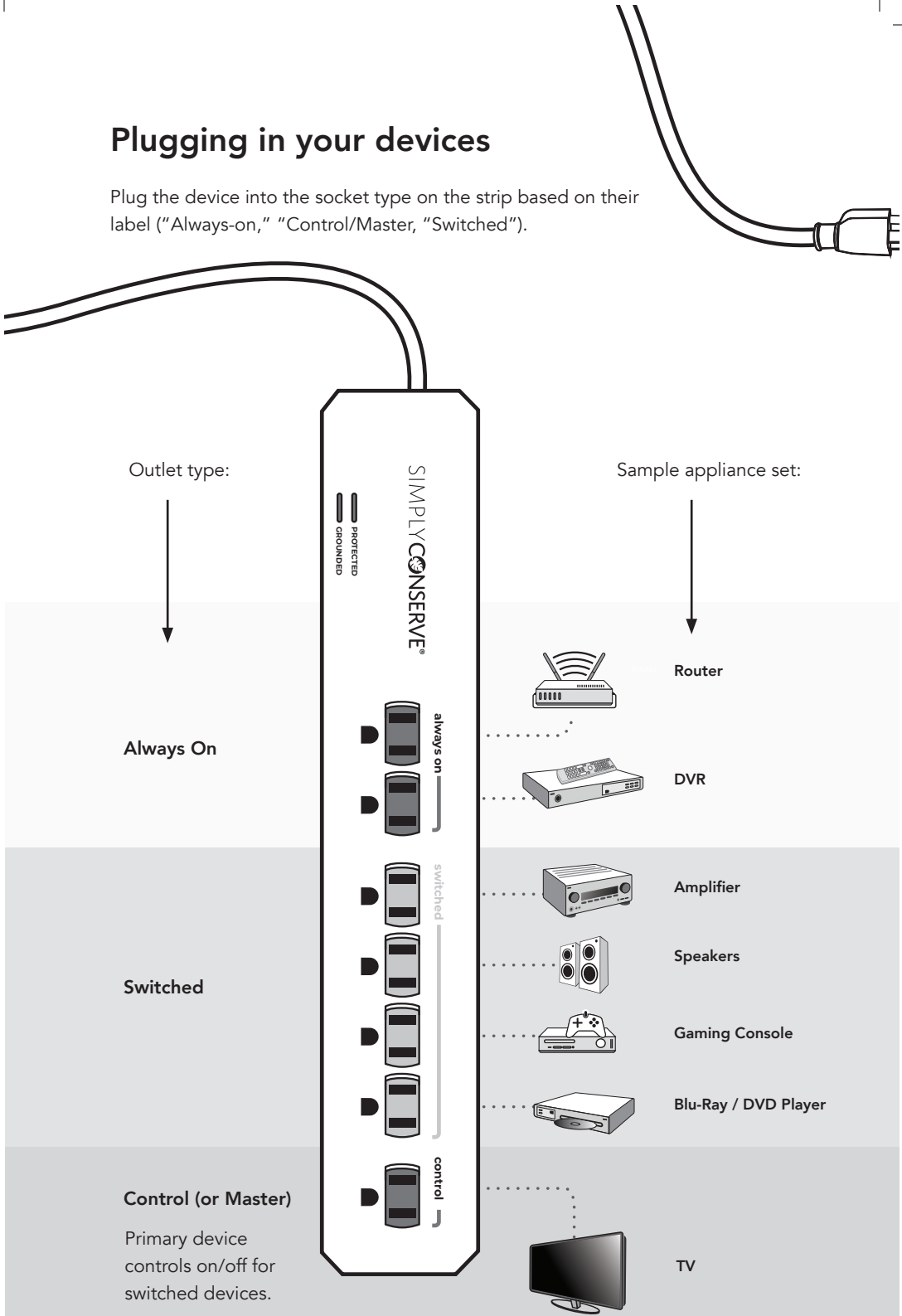

# Weather Proofing

## 3 UNIQUE SOLUTIONS

Control your home's temperature all year long without wasting energy by sealing gaps around doors and windows with these easy-to-install solutions.

- **Weather Stripping (Door Example) | Peel-and-Stick**  
Ensure a tight fit with peel-and-stick adhesive that requires no tools to install.
- **V-Seal Weather Stripping (Window Example) | Adhesive-Backed**  
This adhesive-backed option is a solution for windows that don't form a tight seal. Just cut, fold, and stick.
- **Rope Caulk (Window Example) | No-Mess, Self-Sticking**  
A simple, no-mess solution and a great alternative to tube caulk. Separate a strand, press into place with your fingertips.

## Instructions

### Weather Stripping (Door)

1

#### Measure

On the inside of the door jamb, measure the sides and top.

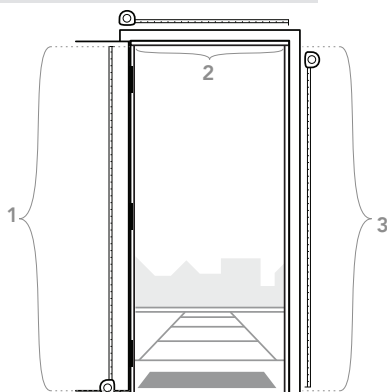

2

**Cut**

Use scissors to cut weather stripping to appropriate length. You need 1 piece for the top and 1 piece for each side, for a total of 3 strips.

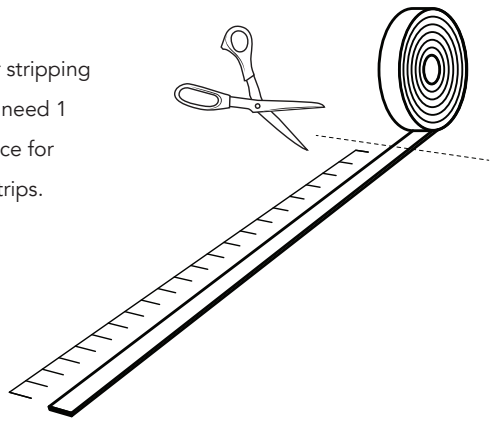

3

**Apply**

Place the end of the weather stripping in the top corner of the jamb. Then, arrange the rest of the pieces to lie flush against the frame. Press firmly to adhere to the door.

Remove any excess with scissors.

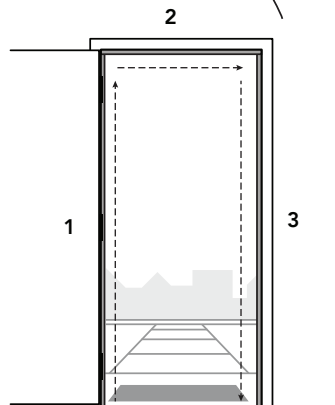
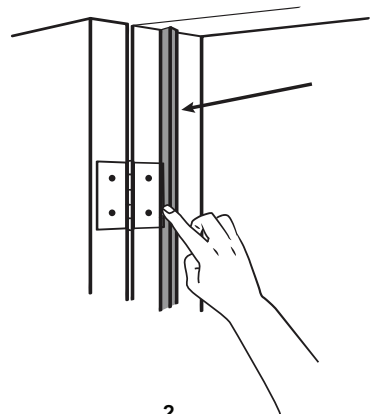

# Instructions

## V-Seal Weather Stripping (Window)

1

### Clean

Wipe the interior of the window frame with rubbing alcohol (if available) and a cloth to remove dirt.

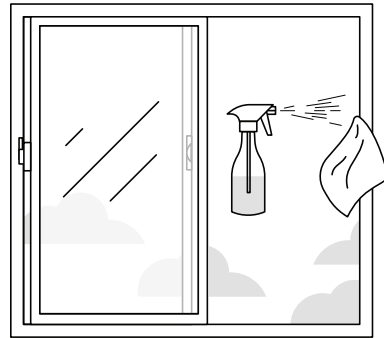

2

### Measure

Measure the interior of the window frame on the closing side.

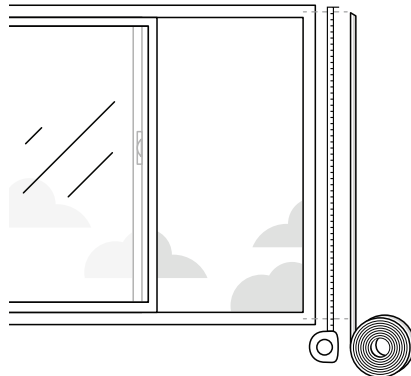

3

### Cut

Use scissors to cut the weather stripping to the appropriate size.

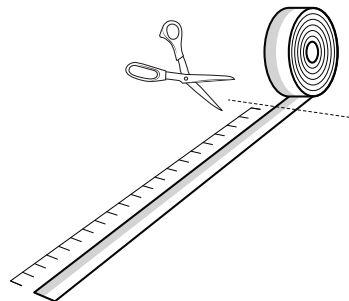

4

**Peel**

Peel off the backing from the adhesive side of the weather stripping.

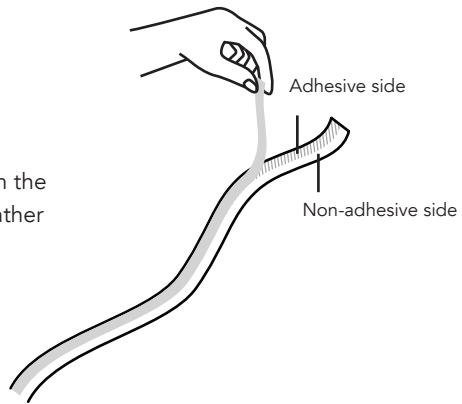

5

**Apply**

Press the adhesive side where the window will meet the frame so that the non-adhesive side will be compressed when the window closes. Trim any excess with scissors.

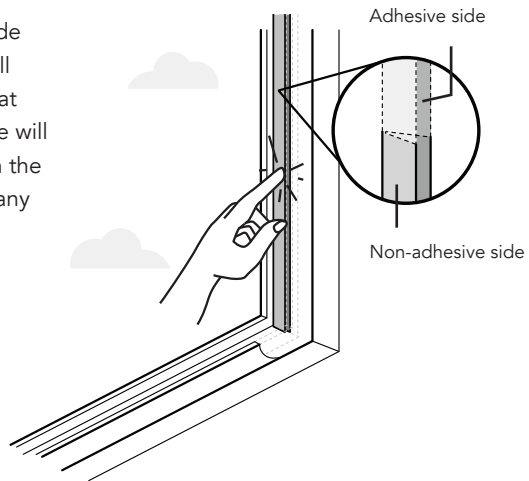

**TIPS:**

- Ensure a dry window frame for optimal adhesion.
- Press firmly along the entire length of the weather stripping.
- Follow manufacturer's instructions regarding orientation.
- For doors, measure the two sides and the top inside the door jamb. Follow steps 3-5.

# Instructions

## Rope Caulk (Window)

1

### Clean

Wipe around the window frame with rubbing alcohol (if available) and a cloth to remove dirt.



2

### Measure

Measure and cut rope caulk for one side.

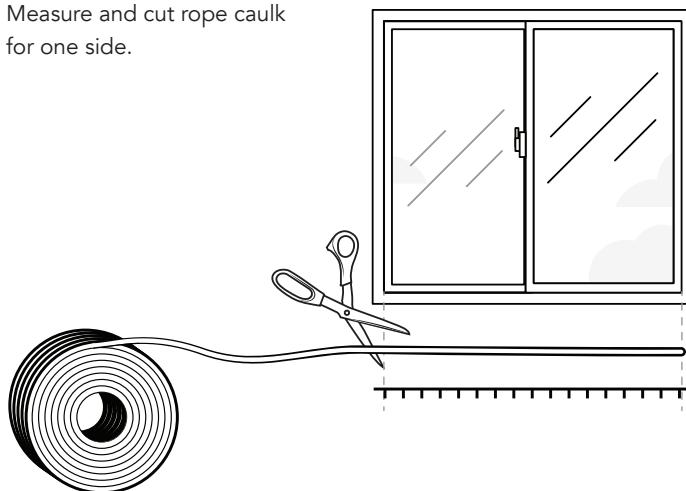

3

**Apply**

Press on firmly where the frame meets the window. Remove any excess caulking material.

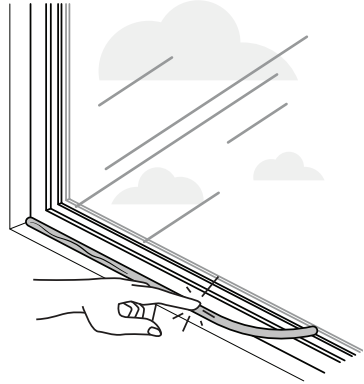

4

**Repeat**

Repeat steps 2 and 3 for the remaining sides.

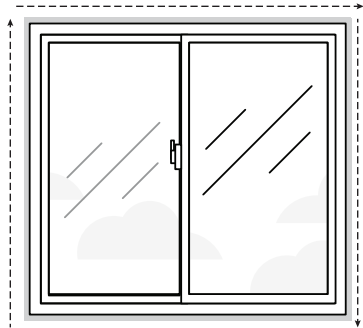

**TIPS:**

- If necessary, knead the material for better pliability.
- Best used on poorly sealed window frames or on a smaller part of the frame if there's an isolated problem area.
- Due to the material, the caulk may come off in smaller pieces but will still function as intended.

## Can't Use Everything?

Share any unused items with friends and family to help them cut costs. Small actions can make a big difference when it comes to saving electricity.

## Share Your Feedback

Sonoma Clean Power's FREE Energy Savings Box enhances your home's energy efficiency and puts more money back in your pocket. Help us continue to deliver exceptional value to our customers by sharing your feedback via the QR code below. **The first 50 people to respond will receive a \$25 gift card.**

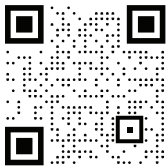

Need help accessing the QR code?  
Call 1-855-202-2139.

## Questions?

We're here to help you.

Email us at [programs@sonomacleanpower.org](mailto:programs@sonomacleanpower.org).